

GO WITH THE CURVE!

Prefabricated curves for drywall installations

The simplest and fastest way to produce smooth curves in drywall.

Prefabricated curves in any radius, shape or size

Simple – Installation is exactly like drywall. Screw in place, tape and finish - just like drywall.

Quick – our pre-fabricated curves save you time and money on the jobsite.

Customizable – select from our hundreds of standard sizes and shapes or send us your dimensions and we'll make exactly what you need.

Wide range of standard products:

- 90 degree outside corners
- 90 degree inside corners
- Column covers
- Arches
- 180 degree end caps
- Coving
- Spherical corners
- Matching base trim
- Custom shapes



Contact us:

Phone: 989 636 1025

Email: curve@fulcrumcomposites.com

Mailing address: Fulcrum Composites Inc, 1407 E. Grove St, Midland, MI 48640, USA

[Tel:989](tel:9896361025) 636 1025

email: info@fulcrumcomposites.com

90 Degree Outside Corners

Description – Used to soften outside corners. Prevents chips and dings that inevitably occur with square corners. Eases passage in tight areas.

Main uses – Residential, commercial/hospitality, medical facilities

Sizes – 2" radius up to 24" radius

[download brochure](#)

90 Degree Outside Corners

½" thick

5/8" thick

Inside radius	Outside radius	8'	10'	Inside radius	Outside radius	8'	10'
2	2 ½	\$55.00	\$75.00	2	2 5/8	\$59.00	\$79.00
2 3/8	2 7/8	\$60.00	\$80.00	2 3/8"	3	\$63.00	\$83.00
3	3 ½	\$65.00	\$85.00	3	3 5/8	\$69.00	\$89.00
3 3/8	3 7/8	\$73.00	\$93.00	3 3/8	4	\$76.00	\$96.00
4	4 ½	\$80.00	\$105.00	4	4 5/8	\$84.00	\$110.00
5	5 1/2	\$82.00	\$107.00	5	5 5/8	\$86.00	\$112.00
5 3/8	5 7/8	\$83.00	\$108.00	5 3/8	6	\$87.00	\$112.00
5 1/2	6	\$83.00	\$108.00	5 1/2	6 1/8	\$87.00	\$112.00
6	6 ½	\$84.00	\$110.00	6	6 5/8	\$88.00	\$115.00
7	7 1/2	\$84.00	\$110.00	7	7 5/8	\$88.00	\$115.00
8	8 ½	\$85.00	\$111.25	8	8 5/8	\$89.00	\$116.25
9	9 1/2	\$89.00	\$113.00	9	9 5/8	\$91.00	\$119.00
10	10 ½	\$91.00	\$116.00	10	10 5/8	\$94.00	\$121.00
11 1/2	12	\$96.00	\$121.00	11 1/2	12 1/8	\$98.00	\$125.00
11 7/8	12 3/8	\$98.00	\$123.00	11 7/8	12 1/2	\$101.00	\$128.00
12	12 1/2	\$99.00	\$124.00	12	12 5/8	\$102.00	\$129.00
13 1/8	13 5/8	\$100.00	\$125.00	13 1/8	13 3/4	\$104.00	\$131.00
13 1/2	14	\$105.00	\$130.00	13 1/2	14 1/8	\$109.00	\$136.00
14	14 ½	\$110.00	\$137.00	14	14 5/8	\$112.00	\$140.00
16	16 ½	\$135.00	\$168.00	16	16 5/8	\$137.00	\$171.00
18	18 ½	\$160.00	\$206.00	18	18 5/8	\$166.00	\$209.00
20	20 ½	\$175.00	\$218.00	20	20 5/8	\$177.00	\$221.00
24	24 1/2	\$230.00	\$290.00	24	24 5/8	\$233.00	\$293.00

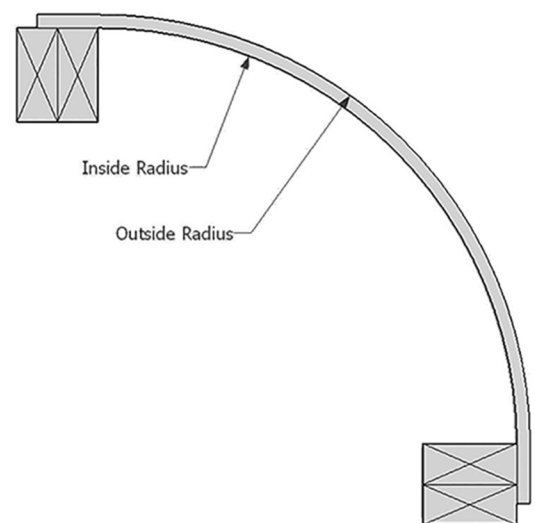

- Outside corners have drywall paper on the convex face, unfinished concave face.
- As standard, corners have a 2 ¼" flat coming off the curve. For maximum corner strength, double up the stud as shown and meet the drywall half-way across the second stud. This makes finishing easier by avoiding floating out a butt on a curve.
- Typically only the end studs are needed. Since the curves are pre-formed, it is not necessary to add multiple studs along the curve to form the drywall around. For radius 12" and above, additional studs should be added at roughly 16" centers to maintain support.
- It is easier to install curved sections first and then butt the flat drywall up to them.
- If you need to cut to length, the easiest way is on a table saw. You can cut with a knife, but unlike drywall, you have to cut all the way through both faces. You cannot cut one face and snap like drywall.



90 Degree Inside Corners

Description - Used to soften inside corners. Eliminates corner dust/dirt/cobweb traps.

Main uses - Residential, commercial/hospitality, medical facilities, cleanrooms

Sizes - 2" radius up to 24" radius

[download brochure](#)

90 Degree Inside Corners

1/2" thick				5/8" thick			
Inside radius	Outside radius	8'	10'	Inside radius	Outside radius	8'	10'
2	2 1/2	\$55.00	\$75.00	2	2 5/8	\$59.00	\$79.00
2 3/8	2 7/8	\$60.00	\$80.00	2 3/8"	3	\$63.00	\$83.00
3	3 1/2	\$65.00	\$85.00	3	3 5/8	\$69.00	\$89.00
3 3/8	3 7/8	\$73.00	\$93.00	3 3/8	4	\$76.00	\$96.00
4	4 1/2	\$80.00	\$105.00	4	4 5/8	\$84.00	\$110.00
5	5 1/2	\$82.00	\$107.00	5	5 5/8	\$86.00	\$112.00
5 3/8	5 7/8	\$83.00	\$108.00	5 3/8	6	\$87.00	\$112.00
5 1/2	6	\$83.00	\$108.00	5 1/2	6 1/8	\$87.00	\$112.00
6	6 1/2	\$84.00	\$110.00	6	6 5/8	\$88.00	\$115.00
7	7 1/2	\$84.00	\$110.00	7	7 5/8	\$88.00	\$115.00
8	8 1/2	\$85.00	\$111.25	8	8 5/8	\$89.00	\$116.25
9	9 1/2	\$89.00	\$113.00	9	9 5/8	\$91.00	\$119.00
10	10 1/2	\$91.00	\$116.00	10	10 5/8	\$94.00	\$121.00
11 1/2	12	\$96.00	\$121.00	11 1/2	12 1/8	\$98.00	\$125.00
11 7/8	12 3/8	\$98.00	\$123.00	11 7/8	12 1/2	\$101.00	\$128.00
12	12 1/2	\$99.00	\$124.00	12	12 5/8	\$102.00	\$129.00
13 1/8	13 5/8	\$100.00	\$125.00	13 1/8	13 3/4	\$104.00	\$131.00
13 1/2	14	\$105.00	\$130.00	13 1/2	14 1/8	\$109.00	\$136.00
14	14 1/2	\$110.00	\$137.00	14	14 5/8	\$112.00	\$140.00
16	16 1/2	\$135.00	\$168.00	16	16 5/8	\$137.00	\$171.00
18	18 1/2	\$160.00	\$206.00	18	18 5/8	\$166.00	\$209.00
20	20 1/2	\$175.00	\$218.00	20	20 5/8	\$177.00	\$221.00
24	24 1/2	\$230.00	\$290.00	24	24 5/8	\$233.00	\$293.00

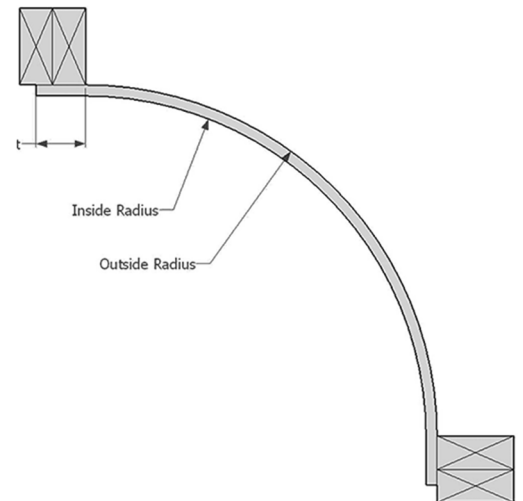

- Inside corners have drywall paper on the concave face, unfinished convex face.
- As standard, corners have a 2 1/4" flat coming off the curve. For maximum corner strength, double up the stud as shown and meet the drywall half-way across the second stud. This makes finishing easier by avoiding floating out a butt on a curve.
- Typically only the end studs are needed. Since the curves are pre-formed, it is not necessary to add multiple studs along the curve to form the drywall around. For radius 12" and above, additional studs should be added at roughly 16" centers to maintain support.
- It is easier to install curved sections first and then butt the flat drywall up to them.
- If you need to cut to length, the easiest way is on a table saw. You can cut with a knife, but unlike drywall, you have to cut all the way through both faces. You can't cut one face and snap like drywall.



Column Covers

Description – Used to finish steel or concrete columns.

Main uses – Commercial, hospitality, retail, medical facilities, car dealerships

Sizes – 6" outside diameter up to 30" OD for two piece columns.
Larger diameters can be produced in 3 or 4 pieces

[download brochure](#)

Column Covers (1/2" thick)

Full Column (360 degrees, 2 pieces)				Half Column (180 degrees, 1 piece)			
Inside diameter	Outside diameter			Inside diameter	Outside diameter		
		8' long	10' long			8' long	10' long
7	8	\$160.00	\$220.00	7	8	\$85.00	\$115
8	9	\$166.00	\$222.00	8	9	\$88.00	\$116.00
9	10	\$172.00	\$224.00	9	10	\$91.00	\$117.00
9.5	10.5	\$174.00	\$226.00	9.5	10.5	\$92.00	\$118.00
11	12	\$180.00	\$230.00	11	12	\$95.00	\$118.50
12	13	\$200.00	\$234.00	12	13	\$105.00	\$122.00
14	15	\$220.00	\$240.00	14	15	\$115.00	\$125.50
15	16	\$240.00	\$260.00	15	16	\$125.00	\$135.00
16	17	\$250.00	\$268.00	16	17	\$128.00	\$138.00
19	20	\$260.00	\$275.00	19	20	\$135.00	\$142.50
23	24	\$300.00	\$300.00	23	24	\$145.00	\$160.00
24	25	\$310.00	\$320.00	24	25	\$150.00	\$165.00
26 1/2	27 1/2	\$315.00	\$330.00	26 1/2	27 1/2	\$160.00	\$175.00
28	29	\$320.00	\$365.00	28	29	\$165.00	\$185.00
29	30	\$330.00	\$400.00	29	30	\$170.00	\$205.00
30	31	\$340.00	\$410.00	\$30.00	\$31.00	\$175.00	\$210.00

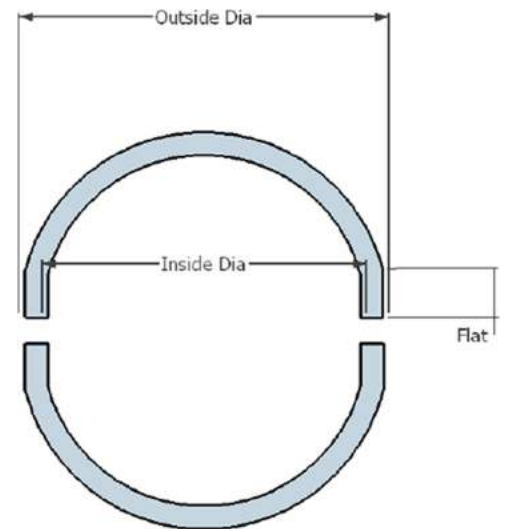

- Column covers have drywall paper on the outside (convex) face, unfinished inside.
- Covers have a short flat where the two halves meet. This allows the finisher to 'bury' the taped joint within the round profile. This makes finishing easier by avoiding floating out a butt around the curve. A curved sanding block is included to make finishing easier.
- Typically only the end studs are needed. Since the curves are pre-formed, it is not necessary to add multiple studs along the curve to form the drywall around. For diameter 18" and above, additional studs should be added at roughly 16" centers to maintain support.
- For larger columns, it is sometimes easier to cinch the two halves together with a belt and ratchet to hold in place while screwing off.
- If you need to cut to length, the easiest way is on a table saw. You can cut with a knife, but unlike drywall, you have to cut all the way through both faces. You can't cut one face and snap like drywall.



Arches

Description – Used to create round or parabolic arches in open doorways. Also blind arches for decorative nooks.

Main uses – Residential open doorways

Sizes – Round and parabolic/elliptical to fit standard 30", 36" and 48" openings. 4" & 8" radius to fit any size opening. Standard width to match 3 1/2" stud wall.

[download brochure](#)

Arches and Rounded Doorways (all 1/2" thick)

Inside radius		
4	\$21 pair	Rounded Corner (any size opening)
8	\$25 pair	Rounded Corner (any size opening)
15	\$32	Round Arch for 30" opening (31" framed)
18	\$38	Round Arch for 36" opening (37" framed)
15 / 7 1/2	\$32	Elliptical Arch for 30" opening (31" framed)
18 / 9	\$38	Elliptical Arch for 36" opening (37" framed)
24	\$45	Round Arch for 40" opening (41" framed)
Notes		
Standard is 3 1/2" wide to fit standard stud wall – other widths on request		
Standard is 1/2" thick - 5/8" available on request		

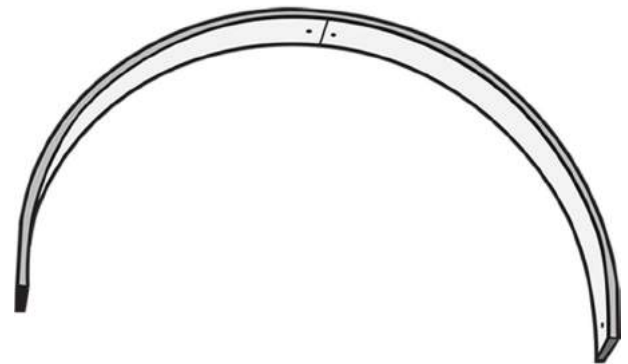

- Arches have drywall paper on the inside concave face, unfinished outside face.
- Screw in place. Add one or more pieces of scrap 2x4 blocking on the outside of the arch, screwed from the inside. Use strips of scrap drywall to build out the rest of the doorframe. Put a full sheet of drywall over the door frame and screw to frame, studs and added blocking. Roto-zip the opening. Finish corner with your preferred trim (Trim-Tex or similar).





180 Degree End Caps

Description - Used to finish the open end on a stud wall (doorless openings or blind walls). Prevents chips and dings that inevitably occur with square corners.

Main uses - Residential, commercial, hospitality, retail

Sizes - to fit 3 1/2", 3 5/8", 5 1/2", 7" stud walls

[download brochure](#)

180 Degree Corners							
1/2" thick				5/8" thick			
Inside diameter	Outside diameter	8'	10'	Inside diameter	Outside diameter	8'	10'
3 1/2	4 1/2	\$85.00	\$111.00	3 1/2	4 3/4	\$89.00	\$116.00
3 5/8	4 5/8	\$85.00	\$111.00	3 5/8	4 7/8	\$89.00	\$116.00
4 1/2	5 1/2	\$100.00	\$123.00	4 1/2	5 3/4	\$105.00	\$125.00
6	7	\$110.00	\$130.00	6	7 1/4	\$115.00	\$135.00
7	8	\$120.00	\$136.00	7	8 1/4	\$124.00	\$160.00

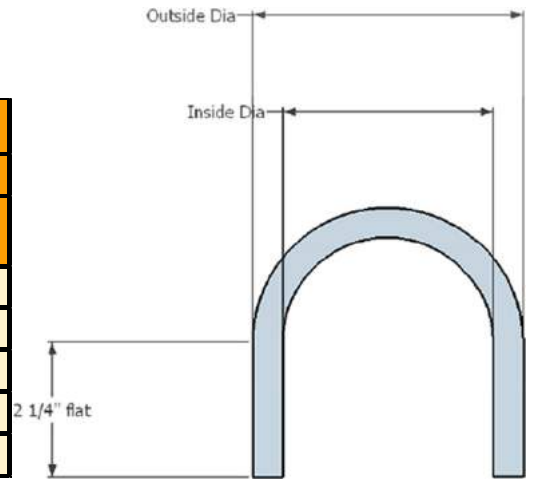

- End caps have drywall paper on the outer face, unfinished inside face.
- As standard, corners have a 2 1/4" flat coming off the curve. For maximum corner strength, double up the stud as shown and meet the drywall half-way across the second stud. This makes finishing easier by avoiding floating out a butt on a curve.
- It is easier to install curved sections first and then butt the flat drywall up to them.
- If you need to cut to length, the easiest way is on a table saw. You can cut with a knife, but unlike drywall, you have to cut all the way through both faces. You can't cut one face and snap like drywall.



Coving

Description - Used to create curved transitions from walls to ceilings

Main uses - Residential, matching plaster coving when remodeling older homes, commercial, hospitality, retail, medical facilities, cleanrooms

Sizes - 2" radius up to 24" radius

Coving							
1/2" thick				5/8" thick			
Inside radius	Outside radius	8'	10'	Inside radius	Outside radius	8'	10'
2	2 1/2	\$55.00	\$75.00	2	2 5/8	\$59.00	\$79.00
2 3/8	2 7/8	\$60.00	\$80.00	2 3/8"	3	\$63.00	\$83.00
3	3 1/2	\$65.00	\$85.00	3	3 5/8	\$69.00	\$89.00
3 3/8	3 7/8	\$73.00	\$93.00	3 3/8	4	\$76.00	\$96.00
4	4 1/2	\$80.00	\$105.00	4	4 5/8	\$84.00	\$110.00
5	5 1/2	\$82.00	\$107.00	5	5 5/8	\$86.00	\$112.00
5 3/8	5 7/8	\$83.00	\$108.00	5 3/8	6	\$87.00	\$112.00
5 1/2	6	\$83.00	\$108.00	5 1/2	6 1/8	\$87.00	\$112.00
6	6 1/2	\$84.00	\$110.00	6	6 5/8	\$88.00	\$115.00
7	7 1/2	\$84.00	\$110.00	7	7 5/8	\$88.00	\$115.00
8	8 1/2	\$85.00	\$111.25	8	8 5/8	\$89.00	\$116.25
9	9 1/2	\$89.00	\$113.00	9	9 5/8	\$91.00	\$119.00
10	10 1/2	\$91.00	\$116.00	10	10 5/8	\$94.00	\$121.00
11 1/2	12	\$96.00	\$121.00	11 1/2	12 1/8	\$98.00	\$125.00
11 7/8	12 3/8	\$98.00	\$123.00	11 7/8	12 1/2	\$101.00	\$128.00
12	12 1/2	\$99.00	\$124.00	12	12 5/8	\$102.00	\$129.00
13 1/8	13 5/8	\$100.00	\$125.00	13 1/8	13 3/4	\$104.00	\$131.00
13 1/2	14	\$105.00	\$130.00	13 1/2	14 1/8	\$109.00	\$136.00
14	14 1/2	\$110.00	\$137.00	14	14 5/8	\$112.00	\$140.00
16	16 1/2	\$135.00	\$168.00	16	16 5/8	\$137.00	\$171.00
18	18 1/2	\$160.00	\$206.00	18	18 5/8	\$166.00	\$209.00
20	20 1/2	\$175.00	\$218.00	20	20 5/8	\$177.00	\$221.00
24	24 1/2	\$230.00	\$290.00	24	24 5/8	\$233.00	\$293.00

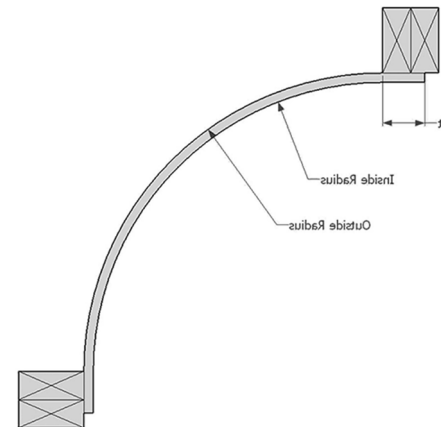

- Coves have drywall paper on the inside concave face, unfinished convex face.
- As standard, corners have a 2 1/4" flat coming off the curve. For maximum corner strength, double up the stud as shown and meet the drywall half-way across the second stud. This makes finishing easier by avoiding floating out a butt on a curve.
- Typically only the end studs are needed. Since the curves are pre-formed, it is not necessary to add multiple studs along the curve to form the drywall around. For radius 12" and above, additional studs should be added at roughly 16" centers to maintain support.
- It is easier to install curved sections first and then butt the flat drywall up to them.- If you have a long run of coving, let us know. We can put tapers (like factory edge of drywall) where the curved ends meet to avoid having to float out a butt around the curve.If you need to cut to length, the easiest way is on a table saw. You can cut with a knife, but unlike drywall, you have to cut all the way through both faces. You can't cut one face and snap like drywall.



Spherical Corners

Description – Used to create a spherical transition between coving and inside corners

Main uses – Medical facilities, cleanrooms, cyclorama (Cyc) walls

Sizes – 4", 8", 12", 24" radius

Spherical Corners					
1/2" thick			5/8" thick		
Inside radius	Outside radius	8'	Inside radius	Outside radius	8'
4	4 1/2	\$50.00	4	4 5/8	\$52.00
6	6 1/2	\$60.00	6	6 5/8	\$62.00
8	8 1/2	\$70.00	8	8 5/8	\$72.00
12	12 1/2	\$80.00	12	12 5/8	\$82.00
24	24 1/2	\$230.00	24	24 5/8	\$233.00

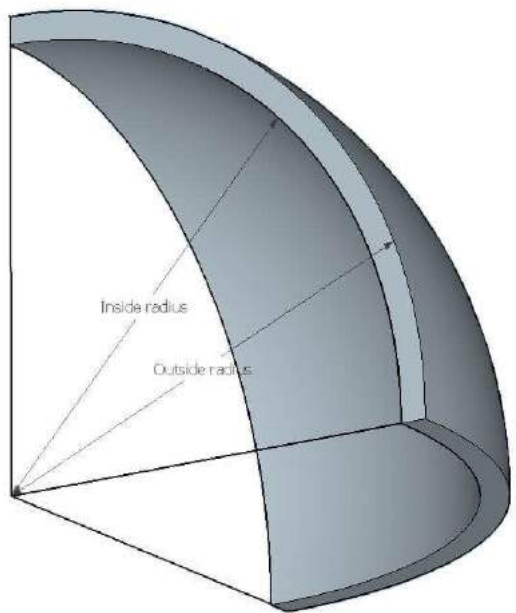

- Spherical corners have drywall paper on the outer face, unfinished inside face.
- Unlike the 2D lengths, spherical corners do not have an extra length of flat coming off the curve.
- It is easier to install spherical corners first, then curved sections and then butt the flat drywall up to them. You will need to cut a 45 degree angle off the 2 1/4" flat on the curved sections.

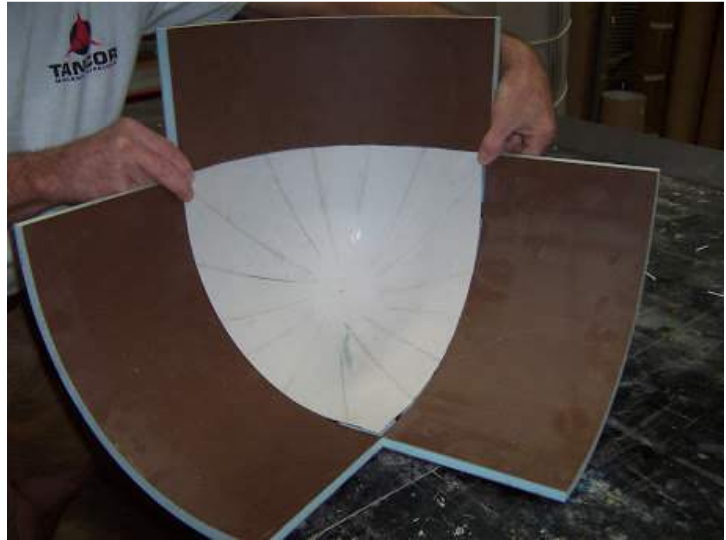



Baseboard Trim Corners

Description – Used as baseboard for rounded corners

Main uses – residential

Sizes – Limited sizes, please inquire

[download brochure](#)

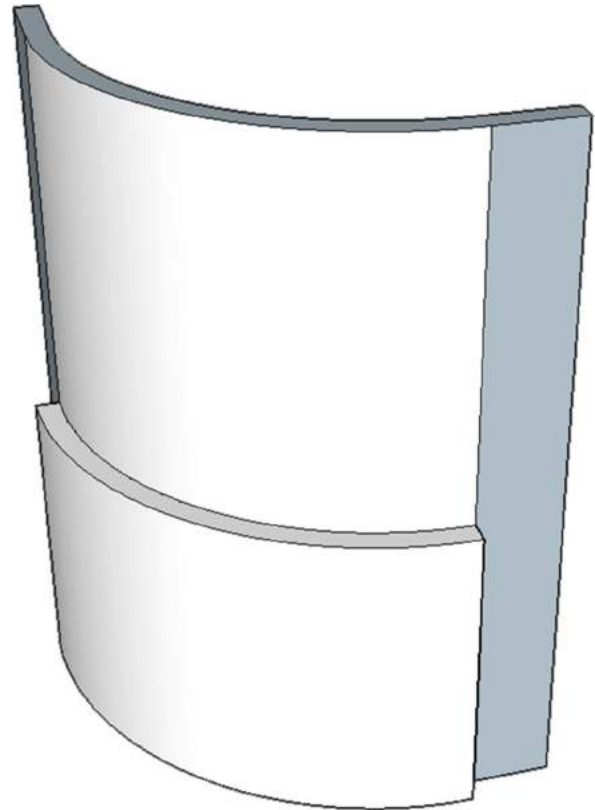

Curved Plywood Base Trim

2-6" high			6-12" high		
Inside radius	Outside radius		Inside radius	Outside radius	
4"	4 5/8"	\$11.00	4"	4 5/8"	\$13.00
8"	8 5/8"	\$15.00	8"	8 5/8"	\$21.00
180 degree wraparound	3 1/2 (dia)	\$14.00	180 degree wraparound	3 1/2 (dia)	\$16.00

- These are 5/8" thick curved plywood.
- They are plain rectangular sections, tops can have a detail such as a radius routed into them.
- Require matching baseboards to be fabricated. Our favorite is to just rip 5/8" MDF to the same height and rout a matching radius onto it, prime & paint.
- Glue to curved corners after they are installed. Note they are 90 degrees and unlike the drywall corners do not have the 2 1/4" flats.
- Corners can be kerfed to better match the curve if needed.



Custom Products

Don't see the perfect product for your needs? No sweat. We can produce custom panels that will match your exact specifications.

Description – Whatever you want! If you need any of our standard products in a different radius, length or thickness, just ask. Plus any kind of one-off – Clouds, Light troughs, decorative ceiling features, elliptical columns, off-angles, Mickey Mouse face... If you can draw it, we'll make it!

Main uses – Commercial, hospitality, retail

Sizes – Whatever you want!

We love unusual requests!

- Off angle corner? As long as you can tell us what the angle is, we'll make a corner to match.
- Architect got a little crazy with a curvy cloud? Send us drawings and we'll make it for you (and probably save a bunch of framing).
- Just want something cool looking? Send us a sketch. We'll help you figure it out!

Ordering

We have lots of options. Please make sure we know exactly what you are looking for:

- Which product – inside corner, outside corner, column cover etc.
- Thickness - ½" or 5/8" (or custom).
- Length 8', 10' (or custom).
- Specify with or without tapered edges (default is without).

Shipping

- Most orders will ship LTL .
- Individual corners 6" radius or less up to 8' long may ship UPS ground. Small items such as arch kits ship USPS Priority Mail.
- Make sure we have your FULL shipping address including if it is a business, jobsite or residential address.

Payment

- Credit card or check with order unless prior credit terms have been established. Checks should be payable to Fulcrum Composites Inc.
- Michigan companies or individuals must pay 6% sales tax.

Contact us

Phone: 989 636 1025

Email: curve@fulcrumcomposites.com

Mailing address: Fulcrum Composites Inc, 1407 E. Grove St, Midland, MI 48640, USA